

21.EXE

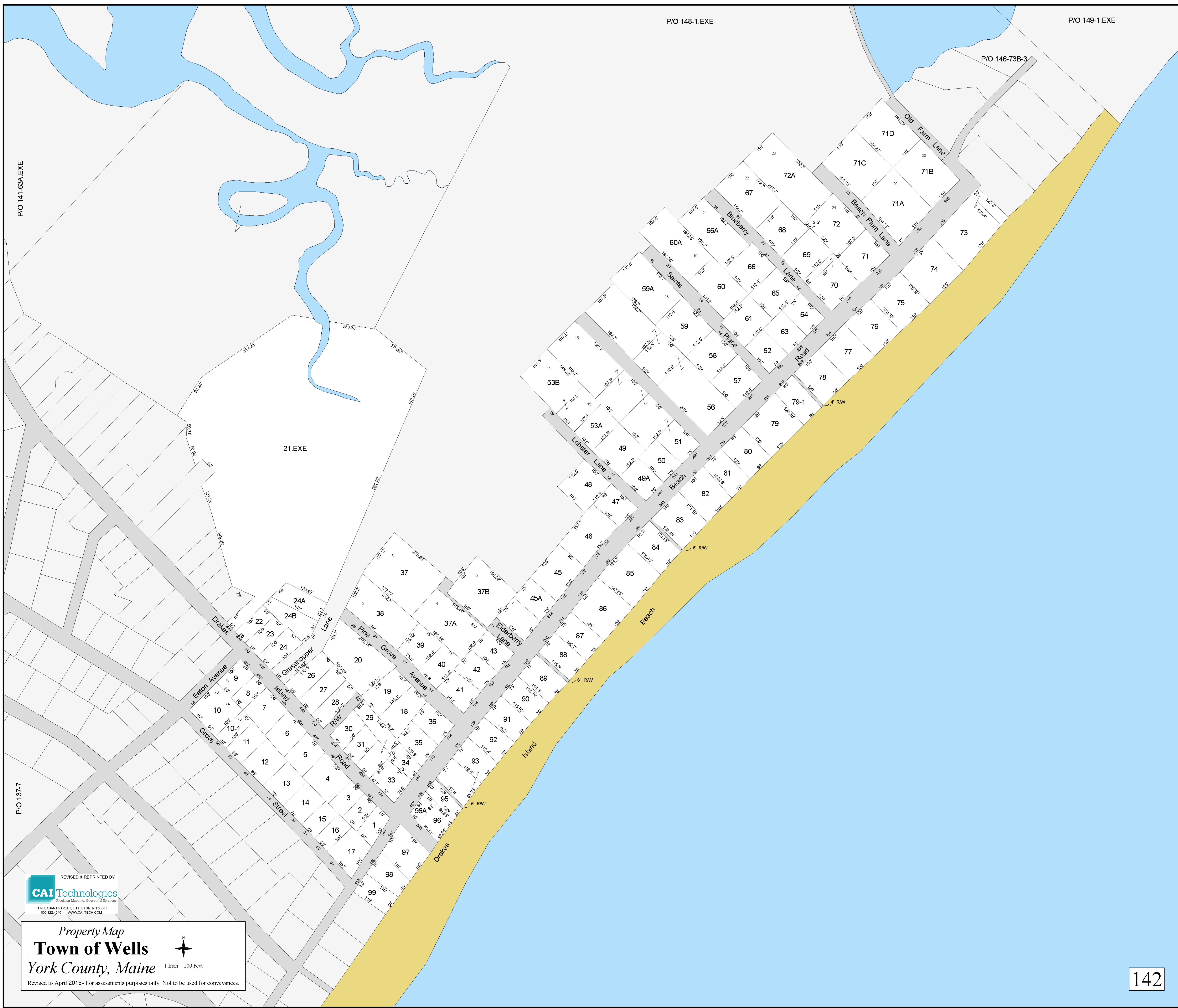

REVISED & REPRINTED BY
CAI Technologies
 Precision Mapping. Geospatial Solutions.
 11 PLEASANT STREET, LITTLETON, NH 03041
 800.322.4540 • WWW.CAI-TECH.COM

Property Map
Town of Wells
York County, Maine 1 Inch = 100 Feet

Revised to April 2015- For assessments purposes only. Not to be used for conveyances.