

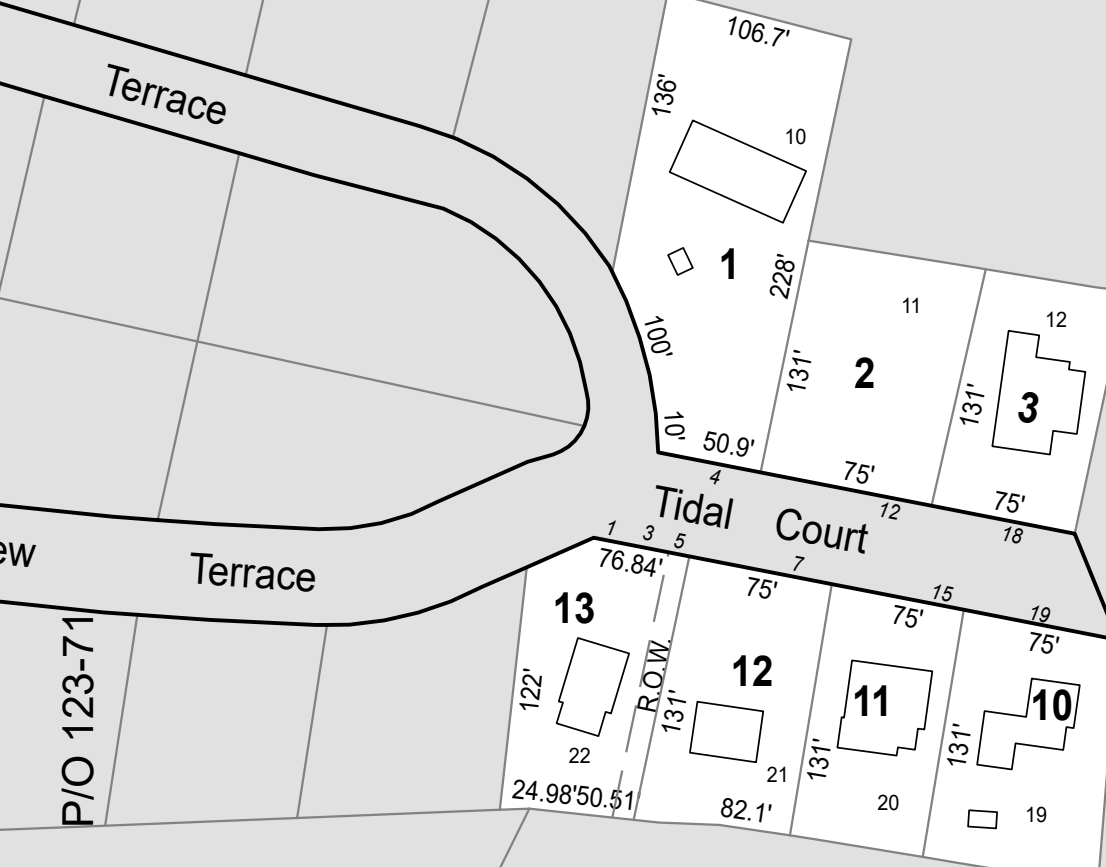

P/O 126-19A P/O 126-19B

P/O 127-2.EXE



P/O 123-71

P/O 123-76

P/O 123-77

P/O 123-80

P/O 123-81A

P/O 123-87

P/O 121-15

P/O 121-13

P/O 121-2.EXE

P/O 122-40.EXE

River

Webhannet

P/O 122-43.EXE

THIS MAP IS FOR ASSESSMENT PURPOSES. IT IS NOT VALID FOR LEGAL DESCRIPTION OR CONVEYANCE.
 THE HORIZONTAL DATUM IS THE MAINE STATE PLANE COORDINATE SYSTEM, NAD 83.
 ORIGINAL MAPPING BY WOODARD & CURRAN

REVISED & REPRINTED BY
CAI Technologies
 Precision Mapping. Geospatial Solutions.
 11 Pleasant Street, Littleton, NH 03561
 603.322.4540 - www.cai-tech.com

LEGEND

RECORD DIMENSION 100'
 SUBDIVISION LOT NO. 2
 WATER

RIGHT OF WAY/ACCESS

COMMON OWNERSHIP

BUILDING

SCALE: 1" = 100'

FEET
 100 50 0 100 200 300

REVISED TO: APRIL 1, 2025

PROPERTY MAPS
WELLS
 YORK COUNTY
 MAINE

INDEX DIAGRAM

 GN

MAP NO.
124