

21.EXE

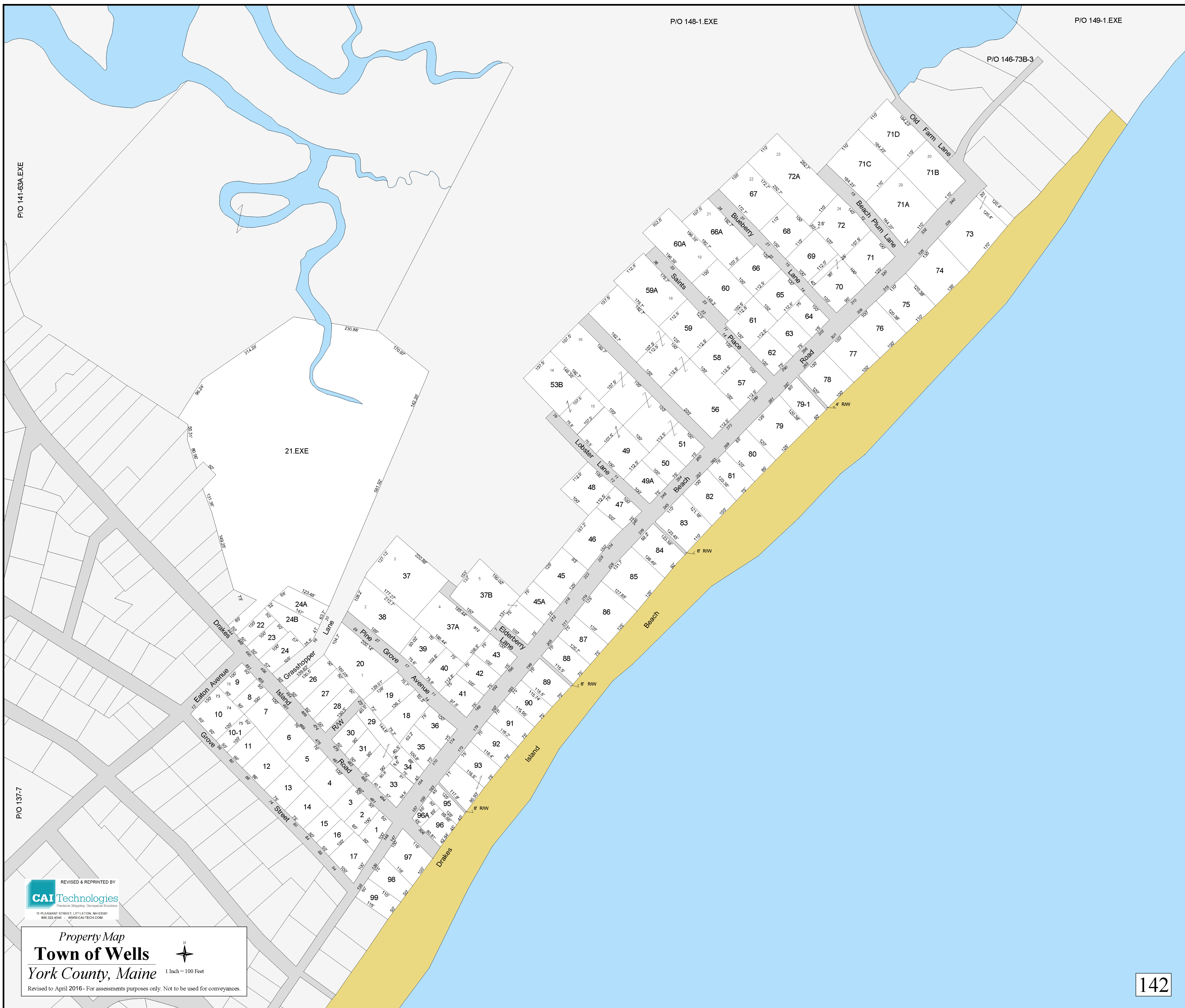

REVISED & REPRINTED BY  
**CAI Technologies**  
 Precision Mapping. Geospatial Solutions.  
 11 PLEASANT STREET, LITTLETON, NH 03051  
 800.322.4540 • WWW.CAI-TECH.COM

*Property Map*  
**Town of Wells**  
*York County, Maine* 1 Inch = 100 Feet

Revised to April 2016- For assessments purposes only. Not to be used for conveyances.